

PRZELICZNIK WAGOWY – PRĘTY ŻEBROWANE –

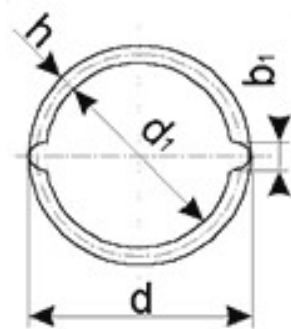

| Wymiar [mm] | Masa [kg/metr] |
|-------------|----------------|
| 5,5 | 0,19 |
| 6 | 0,22 |
| 7 | 0,30 |
| 8 | 0,40 |
| 9 | 0,50 |
| 10 | 0,62 |
| 11 | 0,75 |
| 12 | 0,89 |
| 13 | 1,04 |
| 14 | 1,21 |
| 15 | 1,39 |
| 16 | 1,58 |
| 17 | 1,78 |
| 18 | 2,00 |
| 19 | 2,23 |
| 20 | 2,47 |
| 21 | 2,72 |
| 22 | 2,98 |
| 23 | 3,26 |
| 24 | 3,55 |
| 25 | 3,85 |
| 26 | 4,17 |
| 27 | 4,49 |
| 28 | 4,83 |
| 29 | 5,19 |
| 30 | 5,55 |
| 31 | 5,93 |
| 32 | 6,31 |
| 33 | 6,71 |
| 34 | 7,13 |
| 35 | 7,55 |
| 36 | 7,99 |
| 38 | 8,90 |
| 40 | 9,86 |

| | |
|-----|-------|
| 41 | 10,40 |
| 42 | 10,90 |
| 43 | 11,40 |
| 45 | 12,50 |
| 46 | 13,00 |
| 48 | 14,20 |
| 50 | 15,40 |
| 52 | 16,70 |
| 53 | 17,30 |
| 55 | 18,60 |
| 57 | 20,00 |
| 60 | 22,20 |
| 62 | 23,70 |
| 63 | 24,50 |
| 65 | 26,00 |
| 68 | 28,50 |
| 70 | 30,20 |
| 75 | 34,70 |
| 80 | 39,50 |
| 85 | 44,50 |
| 90 | 49,90 |
| 95 | 55,60 |
| 100 | 61,70 |
| 105 | 68,00 |
| 110 | 74,60 |
| 115 | 81,50 |
| 120 | 88,80 |
| 125 | 96,30 |
| 130 | 104,0 |
| 135 | 112,0 |
| 140 | 121,0 |
| 145 | 130,0 |
| 150 | 139,0 |
| 155 | 148,0 |
| 160 | 158,0 |
| 165 | 168,0 |
| 170 | 178,0 |
| 175 | 189,0 |
| 180 | 200,0 |
| 190 | 223,0 |
| 200 | 247,0 |
| 225 | 312,0 |
| 250 | 385,0 |

Uwagi: Wagi przedstawione w tabeli są wartościami teoretycznymi nie uwzględniającymi gęstości konkretnego stopu oraz tolerancji wykonania.